



Check, correct and reflect!

Book Knowledge Organiser – Portraits

Significant Artists

Marcus Gheeraerts the Younger



Born in Bruges, Marcus Gheeraerts the Younger came to London in 1568 with his father. Gheeraerts' earliest known paintings date from around 1592 and include his celebrated portrait of Queen Elizabeth I. By 1611 Gheeraerts had become a favourite of Queen Anne of Denmark, the wife of King James VI and I.

Leonardo da Vinci



Leonardo da Vinci was a painter, engineer, architect, inventor, and student of all things scientific. His natural genius crossed so many disciplines that he epitomized the term "Renaissance man." Today he remains best known for two of his paintings, "Mona Lisa" and "The Last Supper."

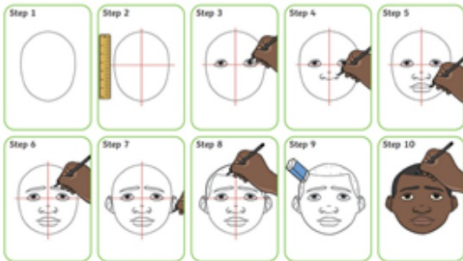

Key Vocabulary

Self-portrait	A portrait an art creates of themselves.
Portrait	A piece of work showing a person.
Technique	A way of carrying out a particular task.
Contour	An outline representing or bounding the shape or form of something.
Tactile	Connected to the sense of touch. What does it feel like?
Palette	The range of colours used by a particular artist or in a particular picture.
Represent	How an artist shows what a person is like in a portrait.

Why do artists paint portraits?

Sometimes they are asked to paint someone and they might be paid for doing so. Sometimes artists create portraits of somebody they admire or love. In the past, portraits were used to memorialise rich and powerful people, such as kings and queens. This meant that the world would remember them after they died. An artist tries to show a person's character so a portrait might show how important someone is, how kind or how strong.



Things to consider when drawing your portrait:

- Skin tone
- Shape of features, in particular your lips.
- Distinguishable features
- What are you trying to say about yourself or your subject.

Set yourself a target! By the end of this topic, what do you want to achieve?

Did you achieve your target? Yes / No

Let's set our target!

Recap

What facial feature did you focus on last year?

What skills have you developed?

How can we use these skills this week in your portrait?

Why this and why now?

LI - To know about the work of a range of artists, craft makers and designers, describing the differences and similarities between different practices and disciplines and making links to their own work.

Leonardo Da Vinci is probably best known as **the famous artist who painted the 'Mona Lisa'**, which has hung in the **Louvre gallery** in Paris for over 200 years.

However he wasn't just a great painter. Da Vinci was **also a sculptor, an architect, a poet, a composer, a scientist, a mathematician and an inventor**. Wow! It's hard to believe that one man could possibly have that many talents.

Leonardo Da Vinci was a **genius** and perhaps one of the most remarkable men that has ever lived.

LI - To know about the work of a range of artists, craft makers and designers, describing the differences and similarities between different practices and disciplines and making links to their own work.

1. What was he most famous for? **Tick one.**

For painting the Mona Lisa.

Being a sculptor.

Being a scientist.

2. True or false?

Leonardo Da Vinci had many talents.

Some Portraits by Famous Artists



How are they
similar?

How are they
different?

Which is your
favourite? Why?

Photo courtesy of Joaqui Martines Rosado, hannahgrove, freeparking © (flickr.com) - granted under creative commons license - attribution

Discussion as a whole class.

This is a very famous painting.

I think the artist has used dark colours because it makes it look realistic.



Mona Lisa (1503-1517)
by Leonardo da Vinci

The artist has used dark colours.

This painting is bright and colourful.

I like the cartoon effect.



Portrait of Madame Matisse (Green Stripe) (1905)
by Henri Matisse

This painting makes me happy because it is vibrant.

Plenary...



“Can you spot **one thing that is the same** in these portraits?”

“Can you spot **one thing that is different?**”

Reflection



inquisitive

Ask questions and enjoy exploring and investigating!



resilient

Are you determined, patient and focused? Always keep trying, especially when challenged!



imaginative

Are you original and ingenious? Can you spot connections and links?



reflective

Be honest when you self-assess. What did you find tricky? What are the links in your learning?



rational

Are you methodical and analytical? It is important to plan and predict!

Reflection

Tick one to show how you have worked this lesson.

Reflective	<input type="checkbox"/>	Imaginative	<input type="checkbox"/>
Rational	<input type="checkbox"/>	Proactive	<input type="checkbox"/>
Inquisitive	<input type="checkbox"/>	Sociable	<input type="checkbox"/>
Resilient	<input type="checkbox"/>	Independent	<input type="checkbox"/>
Adventurous	<input type="checkbox"/>		<input type="checkbox"/>

How?



Check, correct and reflect!

Recap

What facial feature did you focus on last year?

What have you learnt?

How can we use these skills this week in your portrait?

Why this and why now?

Book Knowledge Organiser – Portraits

Significant Artists

Marcus Gheeraerts the Younger



Born in Bruges, Marcus Gheeraerts the Younger came to London in 1568 with his father. Gheeraerts' earliest known paintings date from around 1592 and include his celebrated portrait of Queen Elizabeth I. By 1611 Gheeraerts had become a favourite of Queen Anne of Denmark, the wife of King James VI and I.

Leonardo da Vinci



Leonardo da Vinci was a painter, engineer, architect, inventor, and student of all things scientific. His natural genius crossed so many disciplines that he epitomized the term "Renaissance man." Today he remains best known for two of his paintings, "Mona Lisa" and "The Last Supper."

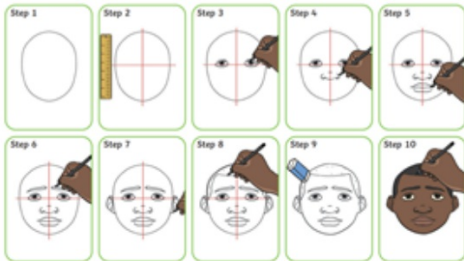

Key Vocabulary

Self-portrait	A portrait an art creates of themselves.
Portrait	A piece of work showing a person.
Technique	A way of carrying out a particular task.
Contour	An outline representing or bounding the shape or form of something.
Tactile	Connected to the sense of touch. What does it feel like?
Palette	The range of colours used by a particular artist or in a particular picture.
Represent	How an artist shows what a person is like in a portrait.

Why do artists paint portraits?

Sometimes they are asked to paint someone and they might be paid for doing so. Sometimes artists create portraits of somebody they admire or love. In the past, portraits were used to memorialise rich and powerful people, such as kings and queens. This meant that the world would remember them after they died. An artist tries to show a person's character so a portrait might show how important someone is, how kind or how strong.



Things to consider when drawing your portrait:

- Skin tone
- Shape of features, in particular your lips.
- Distinguishable features
- What are you trying to say about yourself or your subject.

Set yourself a target! By the end of this topic, what do you want to achieve?

Did you achieve your target? Yes / No

Let's set our target!

LI - To use a range of materials creatively to design and make products.

LI - To use drawing, painting and sculpture to develop and share their ideas, experiences and imagination.

Match the words to their definition:

Self-portrait

Portrait

Technique

A piece of work showing a person.

A portrait an art creates of themselves.

A way of carrying out a particular task.

LI - To use a range of materials creatively to design and make products.

LI - To use drawing, painting and sculpture to develop and share their ideas, experiences and imagination.

This one to go on piccollage.

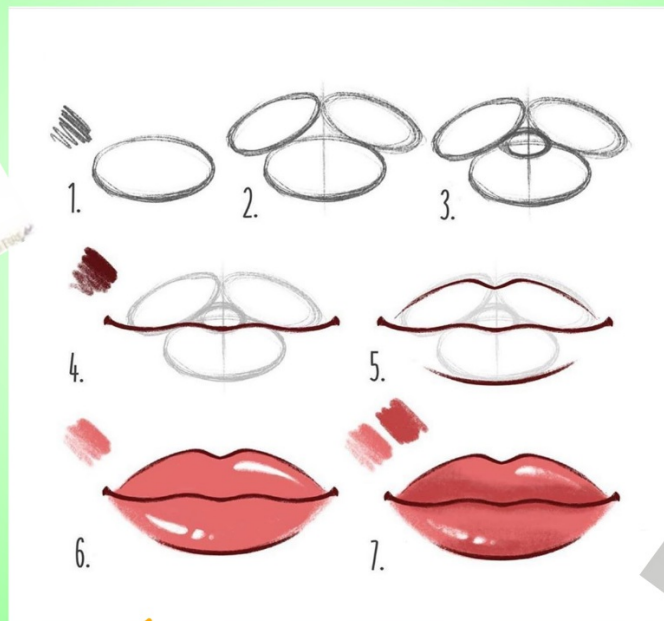

en to have scrap
to practice on while
ing the video.



Click for video!

Children to split page into four equal parts.
Adults could do this prior to the lesson.

shading

paint

**Model your own at the front.
Do each one at a time.**

pastels

tissue paper

Plenary...

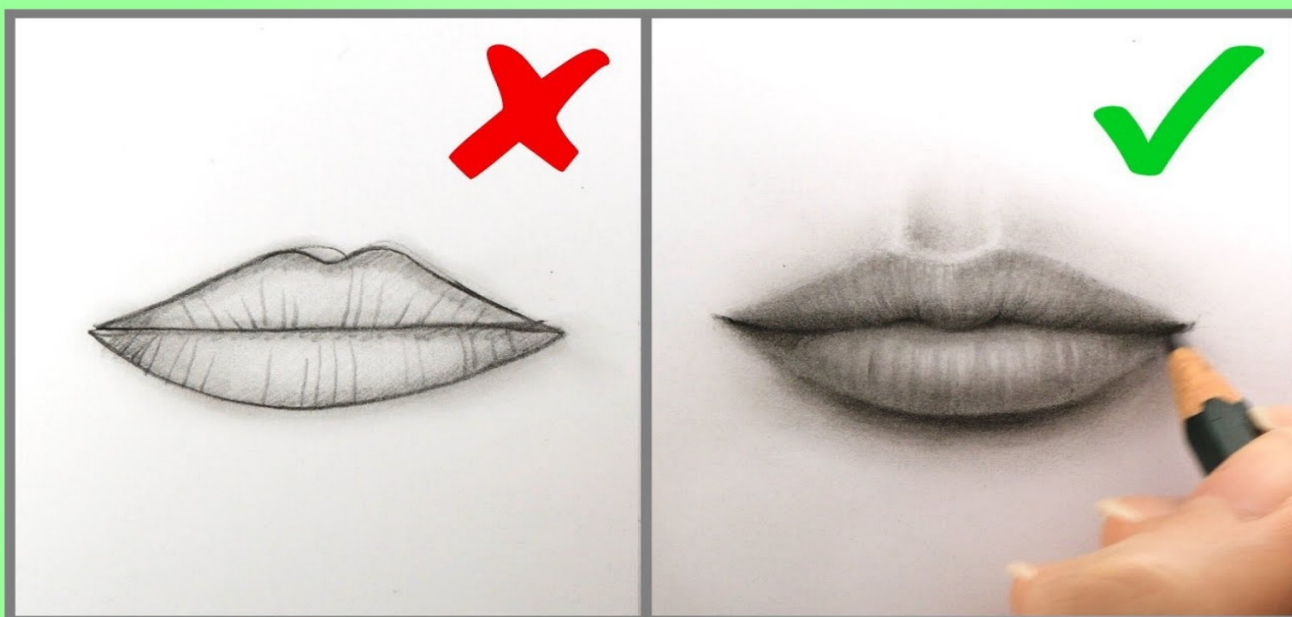

Compare the drawings of lips.

Reflection



inquisitive

Ask questions and enjoy exploring and investigating!



resilient

Are you determined, patient and focused? Always keep trying, especially when challenged!



imaginative

Are you original and ingenious? Can you spot connections and links?



reflective

Be honest when you self-assess. What did you find tricky? What are the links in your learning?



rational

Are you methodical and analytical? It is important to plan and predict!

Reflection

Tick one to show how you have worked this lesson.

Reflective	<input type="checkbox"/>	Imaginative	<input type="checkbox"/>
Rational	<input type="checkbox"/>	Proactive	<input type="checkbox"/>
Inquisitive	<input type="checkbox"/>	Sociable	<input type="checkbox"/>
Resilient	<input type="checkbox"/>	Independent	<input type="checkbox"/>
Adventurous	<input type="checkbox"/>		<input type="checkbox"/>

How?



Check, correct and reflect!

Recap

What facial feature did you focus on last year?

What have you learnt?

How can we use these skills this week in your portrait?

Why this and why now?

LI - Record facial features from first hand

To draw a self - portrait you need a mirror.

Look at your face. What colour are your eyes? What colour is your hair? Do you wear glasses?

These are the things you will need to remember for your picture.



Make sure you have your piece of paper this way

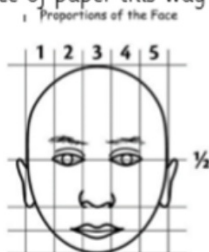

This is the correct way to draw a portrait.

1. What do you need to draw a self-portrait?

You need a _____.

2. Name two things you will need to remember to draw your picture.

1. _____

2. _____

3. Which way do you need your paper? **Tick one.**

Portrait

Landscape

LI - Record facial features from first hand observations.



LI - Record facial features from first hand observations.

What is a Portrait?



A portrait is a picture of a one person or a small group of people.

People can make portraits in lots of ways, using different materials, techniques, equipment, and colours.



What can you use to make a portrait?

Have you created a portrait before?

LI - Record facial features from first hand observations.

Why do Artists Paint Portraits?

Sometimes artists are asked to create a portrait for somebody. They may get paid to do so.

Sometimes artists create portraits of somebody they admire or love.



Portrait of King Henry VIII (1536)
by Holbein



Portrait of an Infant (1881)
by Renoir

In the past, portraits were mostly used to memorialize rich and powerful people like kings and queens. This meant the world would remember them after they died.

An artist often tries to show the person's character so a portrait might show how important someone is, or how kind, or strong.

LI - Record facial features from first hand observations.



Mona Lisa (1503-1517)
by Leonardo da Vinci



Portrait of Madame Matisse (Green Stripe) (1905)
by Henri Matisse

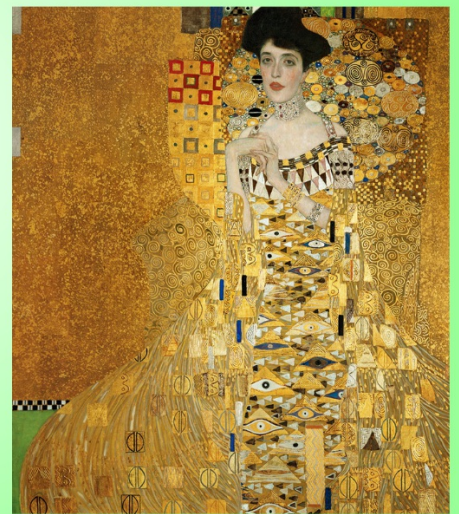

Adele Bloch-Bauer 1 (1907)
by Gustav Klimt

LI - Record facial features from first hand observations.

Take a look at yourself in the mirror.
What do you notice about your features?



LI - Record facial features from first hand observations.

How to draw a portrait



<https://www.bbc.co.uk/teach/class-clips-video/how-to-draw-a-portrait/zk28qp3>

LI - Record facial features from first hand observations.

1¹. Draw an egg shape (but remember not all faces are egg shaped!)

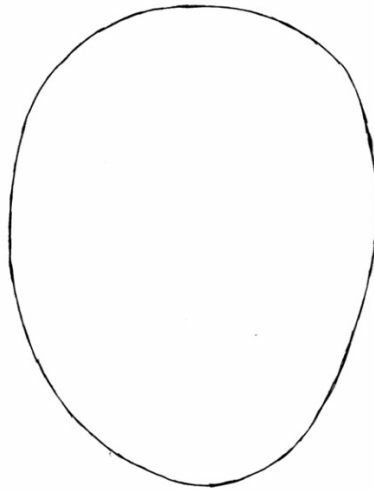

This bit can be difficult so remember to use your pencil **lightly**, just in case you need to rub out mistakes!

LI - Record facial features from first hand observations.

2. Draw a centre line vertically right through the centre of the egg

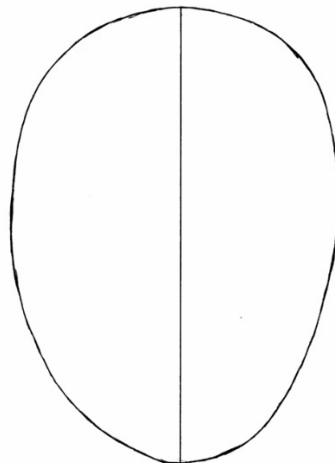

This helps you make sure that you line up the nose, mouth and eyes correctly

LI - Record facial features from first hand observations.

3

3. Draw a horizontal line $\frac{1}{2}$ way down the egg

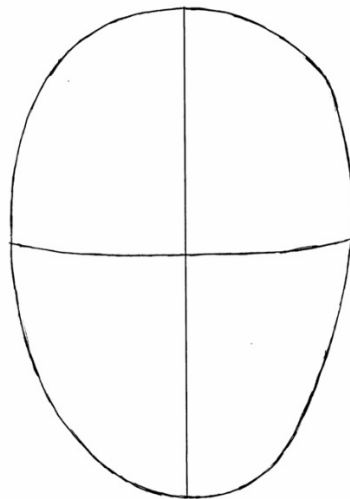

This is where the eyes and top of the ears will go

LI - Record facial features from first hand observations.

4. ⁴ ½ way between the eye line and the chin draw a 2nd horizontal line

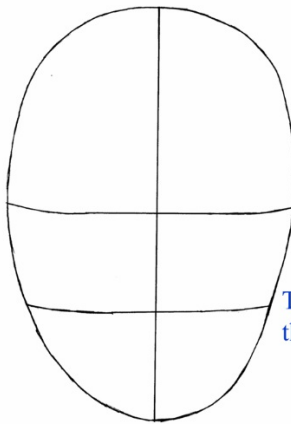

This is where the bottom of the nose and ears will go.

LI - Record facial features from first hand observations.

5. ^s 1/3 of the way down from the nose draw a 3rd horizontal line

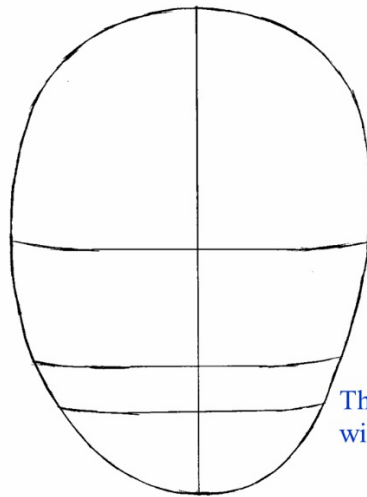

This is where the mouth will go.

Reflection



inquisitive

Ask questions and enjoy exploring and investigating!



resilient

Are you determined, patient and focused? Always keep trying, especially when challenged!



imaginative

Are you original and ingenious? Can you spot connections and links?



reflective

Be honest when you self-assess. What did you find tricky? What are the links in your learning?



rational

Are you methodical and analytical? It is important to plan and predict!

Reflection

Tick one to show how you have worked this lesson.

Reflective	<input type="checkbox"/>	Imaginative	<input type="checkbox"/>
Rational	<input type="checkbox"/>	Proactive	<input type="checkbox"/>
Inquisitive	<input type="checkbox"/>	Sociable	<input type="checkbox"/>
Resilient	<input type="checkbox"/>	Independent	<input type="checkbox"/>
Adventurous	<input type="checkbox"/>		<input type="checkbox"/>

How?

LI - To use drawing, painting and sculpture to develop and share their ideas, experiences and imagination.

We are going to colour our portraits!

Use drawing, painting and sculpture to develop and share their ideas, experiences and imagination.

LI - To be able to identify what they might change in their current work or develop in their future work.

LI – To be able to identify what they might change in their current work or develop in their future work.

Reflection



inquisitive

Ask questions and enjoy exploring and investigating!



resilient

Are you determined, patient and focused? Always keep trying, especially when challenged!



imaginative

Are you original and ingenious? Can you spot connections and links?



reflective

Be honest when you self-assess. What did you find tricky? What are the links in your learning?



rational

Are you methodical and analytical? It is important to plan and predict!

Reflection

Tick one to show how you have worked this lesson.

Reflective		Imaginative	
Rational		Proactive	
Inquisitive		Sociable	
Resilient		Independent	
Adventurous			

How?
